

New Single and Double Yellow Lines at Boswell Gardens and Foster Close

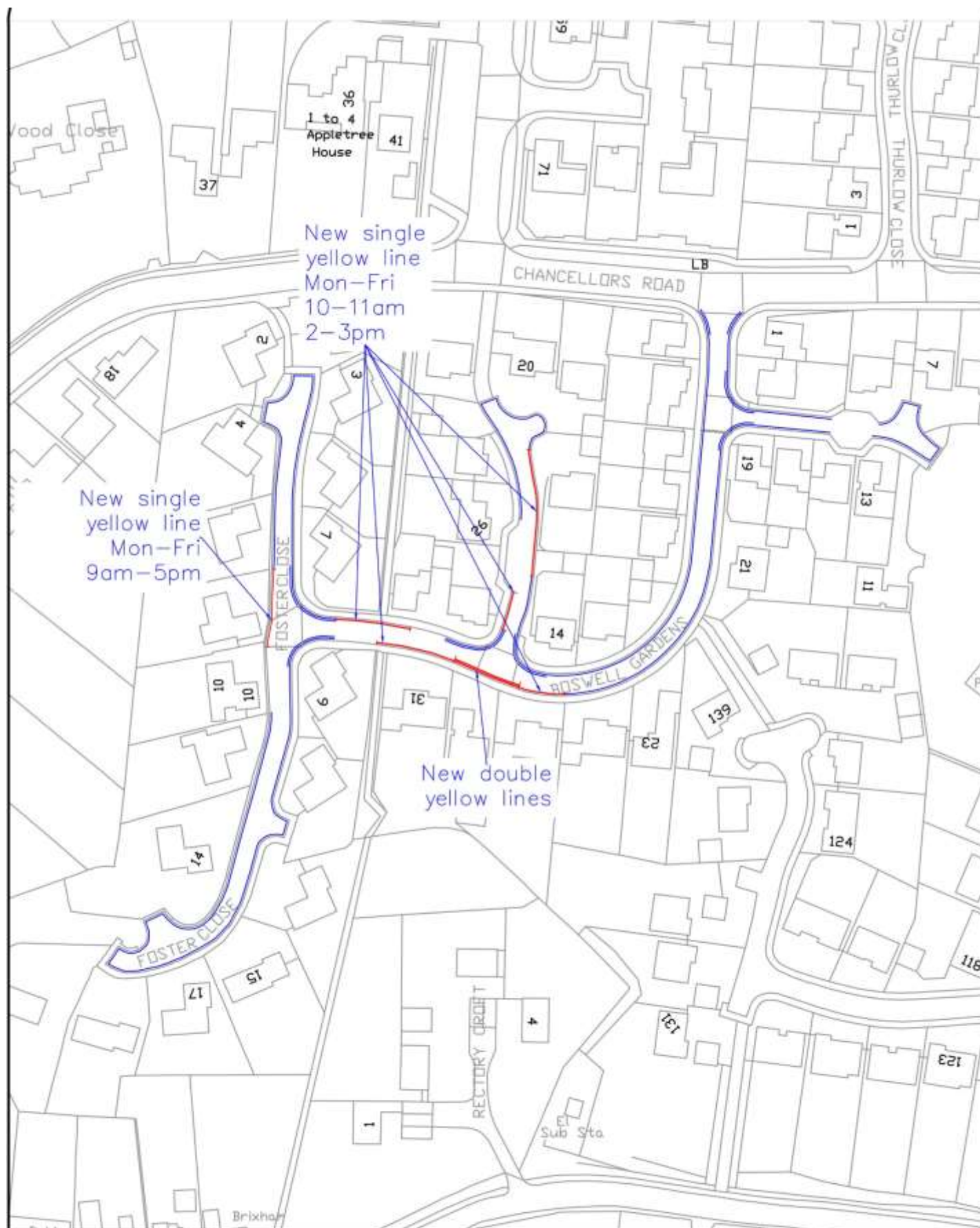

STEVENAGE BOROUGH COUNCIL Zayd Al-Jawad Assistant Director, Planning and Regulation Daneshill House, Danestrete, Stevenage, Herts, SG1 1HN. Telephone: (01438) 242242	PROJECT: Woodfield	DRAWING: New parking restrictions in Boswell Gardens and Foster Close	REV 2	APR 2022
	DATE: 16-09-2021	DRAWN BY: LA	CHECKED: RW	SCALE: 1:1250
			no: Revision Date:	DRAWING NUMBER: TPE/03/21-2/01

