

Plan - Whitney Drive (Restriction of Waiting) Coreys Mill Lane (Pay and Display Amendments)

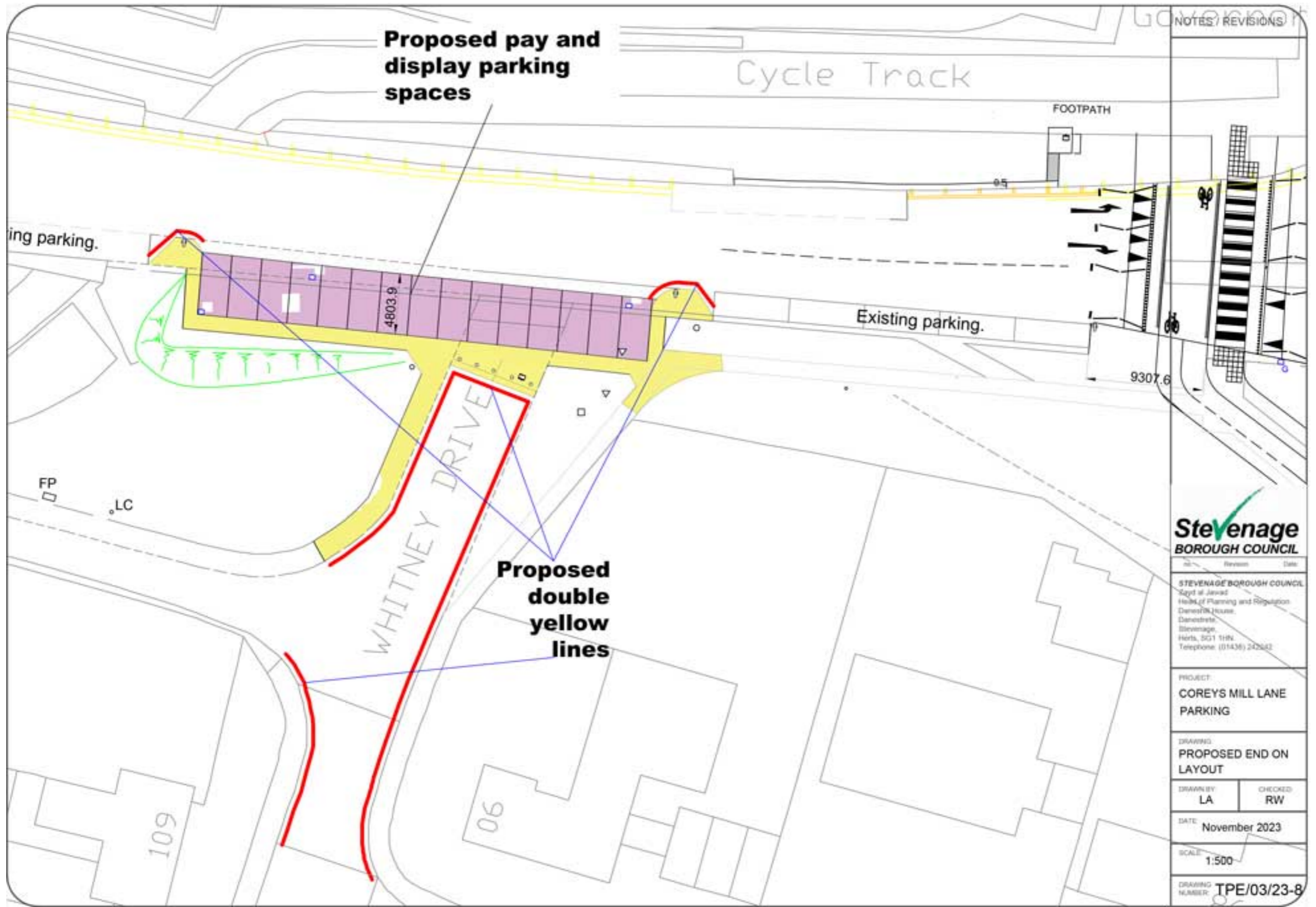

NOTES / REVISIONS

Proposed pay and display parking spaces

Cycle Track

FOOTPATH

ing parking.

Existing parking.

9307.6

WHITNEY DRIVE

Proposed double yellow lines

Stevenage
BOROUGH COUNCIL

STEVENAGE BOROUGH COUNCIL
Sgt of Jerrard
Head of Planning and Regulation
Danes Hill House,
Dane Street,
Stevenage,
Herts, SG1 1HN.
Telephone: (01438) 242543

PROJECT
COREYS MILL LANE
PARKING

DRAWING
PROPOSED END ON
LAYOUT

DRAWN BY: LA
CHECKED: RW

DATE: November 2023

SCALE: 1:500

DRAWING NUMBER: TPE/03/23-8